



**Camelot**  
*Realty*

307 675-1257  
homes@camelotwy.com

2275 Dry Ranch Rd | Sheridan WY



## 235 Weeping Birch

*Another brand new, high-quality custom home by Excalibur Construction!*

Your very own new custom home will be the envy of your friends when they see the beautiful finishes and custom design concepts! A 2,860 SF floor plan with 5-bedrooms and 3-bathrooms and a walk-out basement ideal for entertaining. The floor plan also includes a great room with a vaulted ceiling, mud room, 2-laundry rooms, dining area and a downstairs living room with a wet bar. The kitchen includes custom maple cabinets, granite countertops and a premier appliance package. The master suite is sure to please with great amenities such as a walk-in closet, relaxing jetted tub and large shower.

Visitors will be stunned when they pull up to your beautiful home with a 2-car garage and an exterior that is low maintenance, with seamless metal siding, Pella windows, aluminum: soffit, fascia, rain gutters and beautiful accents. Enjoy outdoor entertaining with family and friends on your front covered porch, deck or rear concrete patio. Your yard also includes sod and sprinkler system! Call today to make your American Dream come true! Includes a one-year contractor's warranty at closing.

*A sound investment at \$399,500* MLS 19-817

### **Camelot Realty, Inc.**

Kathy Arnold, *Broker*  
307-751-3203  
Camelotwy.com



### **Excalibur Construction**

Andy McFaul  
307-752-1259  
Excalibur-1.com

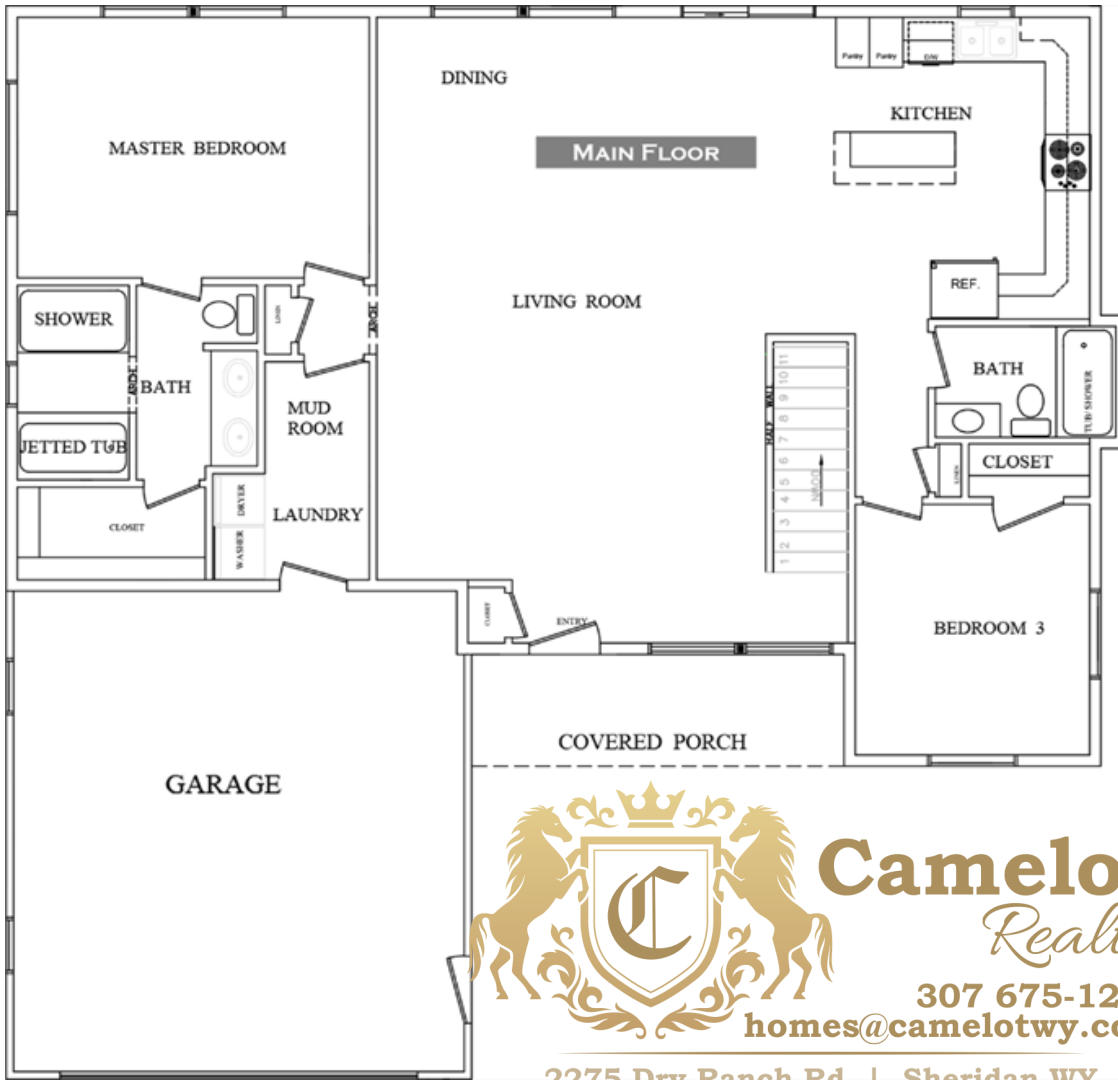

**Camelot**  
*Realty*

307 675-1257  
homes@camelotwy.com

2275 Dry Ranch Rd | Sheridan WY

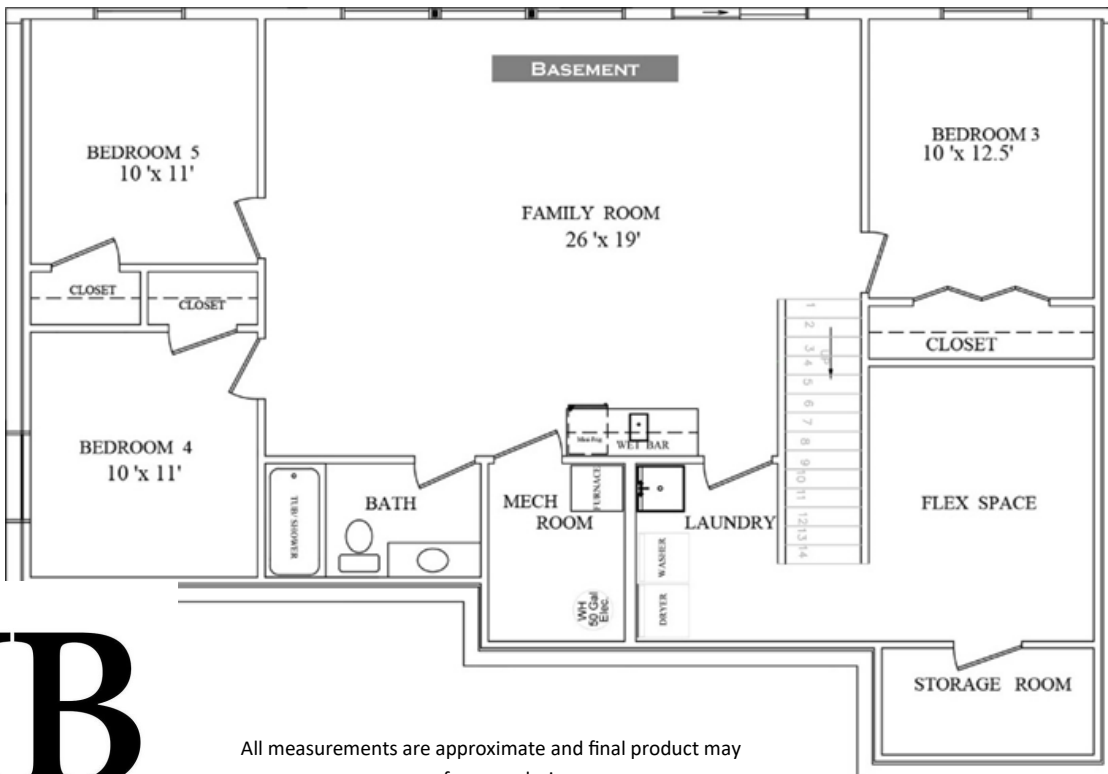

All measurements are approximate and final product may vary from rendering.